

Continuous Support 1CC

Linear Guide #6

with Table Top

*Fully Supported, Highest Performance
 Industry Standard Dimensions*

INCH

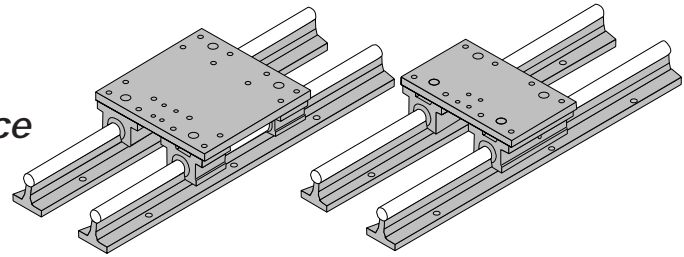

Double Continuously Supported Linear Guide with 4 Pillow Blocks and Size B Table Top

Load Rating and Limit by Direction

	Dynamic Load Rating	Load Limit
F_c	C	C
F_t	0.5C	0.5C
F_s	C	0.5C

Dynamic Load Rating
Load value used in life calculation.
Load Limit
Maximum allowable load applied to bearing.

Double Continuously Supported Linear Guide with 2 Twin Pillow Blocks and Size A Table Top

Continuously Supported Linear Guide 1CC Double with 4 Pillow Blocks and Table Top (Size B) (Dimensions in inches)

Part Number	Nominal Diameter	T1	T	H	B	B2	Maximum Stroke Length	Pillow Block	Shaft Support Rail Assembly
1CC-08-FAB	.50	5.5	5.5	2.187	4.75	3.25	L-(5.5)	SPB-8-OPN-XS	SRA-8-XS
1CC-12-FAB	.75	7.5	7.5	2.937	6.25	4.50	L-(7.5)	SSUPBO-12-XS	SRA-12-XS
1CC-16-FAB	1.00	9.0	9.0	3.437	7.63	5.50	L-(9.0)	SSUPBO-16-XS	SRA-16-XS
1CC-20-FAB	1.25	11.0	11.0	4.375	9.25	6.75	L-(11.0)	SSUPBO-20-XS	SRA-20-XS
1CC-24-FAB	1.50	13.0	13.0	5.000	11.00	8.00	L-(13.0)	SSUPBO-24-XS	SRA-24-XS

Continuously Supported Linear Guide 1CC Double with 2 Twin Pillow Blocks and Table Top (Size A) (Dimensions in inches)

Part Number	Nom. Dia.	T2	T	H	B	B2	Maximum Stroke Length	Pillow Block	Shaft Support Rail Assembly
1CC-08-HAA	.50	3.5	5.5	2.187	4.75	3.25	L-(3.5)	TWN-8-OPN-XS	SRA-8-XS
1CC-12-HAA	.75	4.5	7.5	2.937	6.25	4.50	L-(4.5)	SSUTWNO-12-XS	SRA-12-XS
1CC-16-HAA	1.00	6.0	9.0	3.437	7.63	5.50	L-(6.0)	SSUTWNO-16-XS	SRA-16-XS
1CC-20-HAA	1.25	7.5	11.0	4.375	9.25	6.75	L-(7.5)	SSUTWNO-20-XS	SRA-20-XS
1CC-24-HAA	1.50	9.0	13.0	5.000	11.00	8.00	L-(9.0)	SSUTWNO-24-XS	SRA-24-XS

Dynamic Load Rating (C) Matrix (4 million inches travel)

Linear Guide Assembly Part No.	Dynamic Load Rating, C (lbf) (Even Distribution)	Pillow Block Part No.	Pillow Block Dynamic Load Rating, C (lbf)
1CC-08-FAB	580	SPB-8-OPN-XS	145
1CC-12-FAB	3600	SSUPBO-12-XS	900
1CC-16-FAB	6000	SSUPBO-16-XS	1500
1CC-20-FAB	7460	SSUPBO-20-XS	1865
1CC-24-FAB	12320	SSUPBO-24-XS	3080

Dynamic Load Rating (C) Matrix (4 million inches travel)

Linear Guide Assembly Part No.	Dynamic Load Rating, C (lbf) (Even Distribution)	Pillow Block Part No.	Pillow Block Dynamic Load Rating, C (lbf)
1CC-08-HAA	580	TWN-8-OPN-XS	290
1CC-12-HAA	3600	SSUTWNO-12-XS	1800
1CC-16-HAA	6040	SSUTWNO-16-XS	3020
1CC-20-HAA	7460	SSUTWNO-20-XS	3730
1CC-24-HAA	12320	SSUTWNO-24-XS	6160

Continuously Supported Linear Guide 1CC Benefits:

- Requires only one part number to specify the entire linear guide.
- Includes table top with standard tapped holes for quick and easy mounting of the work piece.
- Includes Ball Screw Assembly attachment holes for ease of assembly and actuation
- Used in continuously supported applications when rigidity is required.

Continuously Supported Linear Guide 1CC Components:†

- 4 Super Smart Ball Bushing* open type pillow blocks or 2 Super Smart Ball Bushing open type twin pillow blocks.
- 2 60 Case* LinearRace* shaft Support Rail Assemblies.
- 1 mounting table top with work piece and Ball Screw Assembly attachment holes.

Specifying a Thomson Linear Guide:

1. Determine the proper system for your load and life requirements.
2. Select the part number.
3. Add the letter "L" followed by the overall length in inches, as a suffix to the part number.

Part Numbering System

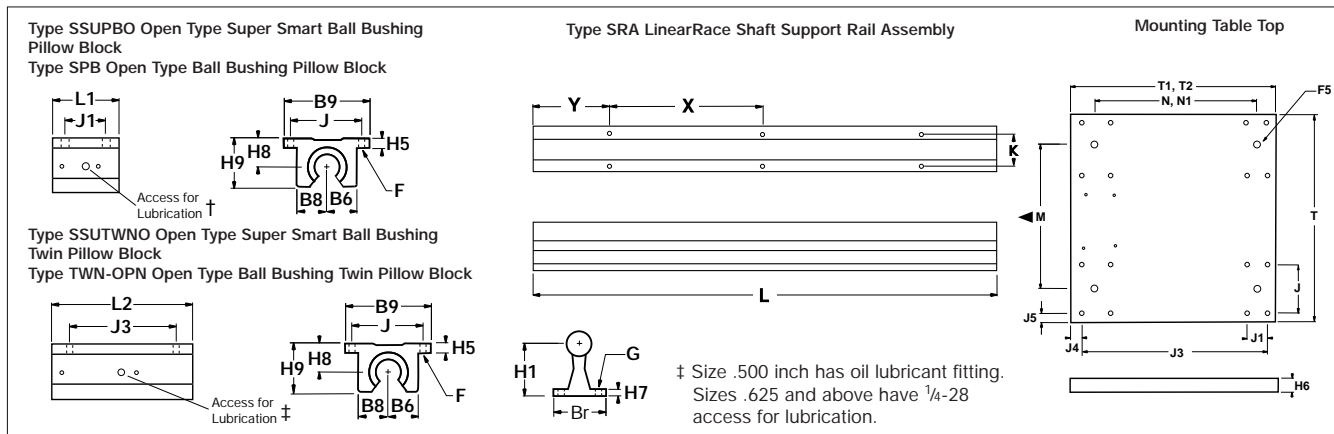
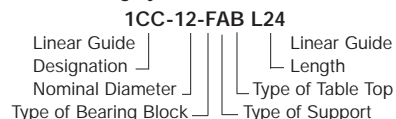

Type SPB-OPN and SSUPBO Pillow Blocks (Dimensions in Inches)													Type TWN-OPN and SSUTWNO Pillow Blocks					
Part Number	Nom. Dia.	L1	H9	H8	H5	B9	B8	B6	J	J1	F		Wt. lb	Part Number	Nom. Dia.	L2	J3	Wt. lb
											Bolt	Hole						
SPB-8-OPN-XS	.50	1.50	1.12	.687	.25	2.00	.75	.69	1.69	1.00	#6	.16	.20	TWN-8-OPN-XS	.50	3.5	2.5	.40
SSUPBO-12-XS	.75	1.88	1.56	.937	.31	2.75	1.00	.94	2.38	1.25	#8	.19	.51	SSUTWNO-12-XS	.75	4.5	3.5	1.02
SSUPBO-16-XS	1.00	2.63	2.00	1.187	.38	3.25	1.25	1.19	2.88	1.75	#10	.22	1.03	SSUTWNO-16-XS	1.00	6.0	4.5	2.06
SSUPBO-20-XS	1.25	3.38	2.56	1.500	.43	4.00	1.63	1.50	3.50	2.00	#10	.22	2.15	SSUTWNO-20-XS	1.25	7.5	5.5	4.30
SSUPBO-24-XS	1.50	3.75	2.94	1.750	.50	4.75	1.88	1.75	4.12	2.50	1/4	.28	3.29	SSUTWNO-24-XS	1.50	9.0	6.5	6.88

Housing Material: Aluminum Alloy Black Anodized

Housing Material: Aluminum Alloy Black Anodized

Type SRA LinearRace Shaft Support Rail Assembly (Dimensions in Inches)												
Part Number	Nom. Dia.	H1	H7	Br	K	X	Y	G		Wt. lb/ft		
								Bolt	Hole			
SRA-8-XS	.50	1.125	.19	1.50	1.00	4	2	#6	.17	1.26		
SRA-12-XS	.75	1.500	.25	1.75	1.25	6	3	#10	.22	2.50		
SRA-16-XS	1.00	1.750	.25	2.13	1.50	6	3	1/4	.28	4.06		
SRA-20-XS	1.25	2.125	.31	2.50	1.88	6	3	5/16	.34	6.30		
SRA-24-XS	1.50	2.500	.38	3.00	2.25	8	4	5/16	.34	8.60		

LinearRace Shaft Support Rail Material: Aluminum Alloy Black Anodized

Maximum length of LinearRace Shaft Support Rail is 72 inches. If longer continuous one-piece LinearRace Shaft Support Rails are required, contact the Thomson Linear Guide Application Engineering department.

Mounting Table Top (Dimensions in inches)																
Nominal Diameter	All Table Tops					Table Top Size B					Table Top Size A					
	T	M	J	H6	F5	T1	J1	J4	J5	N	T2	J3	J4	J5	N1	
.50	5.5	3.25	1.69	.375	1/4-20	5.5	1.00	.34	.28	4.5	3.5	2.5	.50	.31	2.5	
.75	7.5	4.50	2.38	.500	5/16-18	7.5	1.25	.41	.31	6.0	4.5	3.5	.50	.31	3.0	
1.00	9.0	5.50	2.88	.500	3/8-16	9.0	1.75	.53	.31	7.0	6.0	4.5	.75	.31	4.0	
1.25	11.0	6.75	3.50	.750	1/2-13	11.0	2.00	.82	.38	8.5	7.5	5.5	1.00	.38	5.0	
1.50	13.0	8.00	4.12	.750	1/2-13	13.0	2.50	.75	.44	10.0	9.0	6.5	1.25	.44	6.0	

Material: Aluminum Alloy Black Anodized

† Super Ball Bushing* bearings are used in .500 inch size pillow blocks.