

TECNOTION[®]

THE LINEAR MOTOR COMPANY

Frameless Torque Motor Series

Sold & Serviced by



ELECTROMATE

Toll Free Phone: 1-877-SERVOES

Toll Free Fax: 1-877-SERVOES

www.electromate.com

sales@electromate.com

QUALITY AND SERVICE DELIVERED WORLDWIDE

[TECNOTION]

Tecnotion is *the* global authority on direct drive motor technology. We are the world's only unbundled manufacturer of linear and torque motors. A former part of Philips, we specialize solely in the development and production of linear and torque motors. Because of this, our expertise, customer service and product quality are unmatched.

We have a global presence, with production plants in The Netherlands and China and local representation around the world. This ensures short delivery times and high quality support, wherever you are located.

When you do business with Tecnotion, you have a team of highly skilled sales and application engineers at your disposal. They help you from your initial prototype all the way to the application of our products and beyond.

Whatever your needs, you can rely on Tecnotion as a solid, reliable partner.

Sold & Serviced By:



Toll Free Phone (877) SERV098
Toll Free Fax (877) SERV099
www.electromate.com
sales@electromate.com





[SALES SUPPORT]

At Tecnotion we understand that each application of our motors is a unique case with specific requirements and demands.

Our sales and application engineers have extensive experience with a wide range of application types and collaborate on a high level with our customers to make sure you get the solution that best fits your requirements.

Additionally our specialized Simulation Tool is available to help you find your way through our wide range of motors and analyze/test out different motor types within your application specifications.

[INNOVATION]

We have an in-house R&D department, which is continuously pushing the boundaries of technology and taking our products to the next level. This translates directly to our high level of understanding of manufacturing processes.

Apart from our "off-the-shelf" range of standard motors, we can also design and manufacture custom made motors for high profile projects or OEM applications that require a tailor-made solution.

All our custom motors are built to the same high standards that characterize our standard range of products.

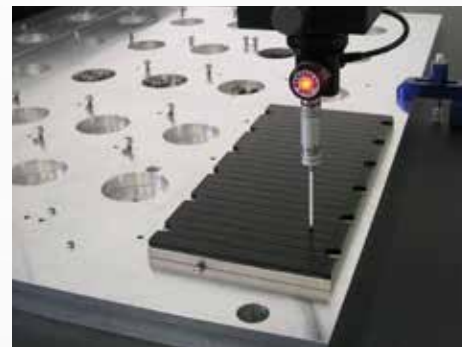

[MANUFACTURING]

Manufacturing of our standard range of motors takes place at our modern plant in China, where we are able to produce in high volume at very competitive rates.

At our competence centre and headquarters in The Netherlands we specialize in advanced technology. This is where we do our research and development and where custom motors are built with extreme accuracy in our special state of the art clean room environment.

Tecnotion is committed to excellence. Both of our plants are ISO 9001 certified and comply to the highest quality standards possible.

[GLOBAL LOGISTICS]

We always have our most popular products in stock in our warehouses in both The Netherlands and China.

Our logistics department can ship to you from both locations, making short delivery times possible across the globe, even when markets are ramping.



Sold & Serviced By:



Toll Free Phone (877) SERV098
Toll Free Fax (877) SERV099
www.electromate.com
sales@electromate.com

Frameless torque motors

Overview of the complete range



Tecnotion's torque motor power range

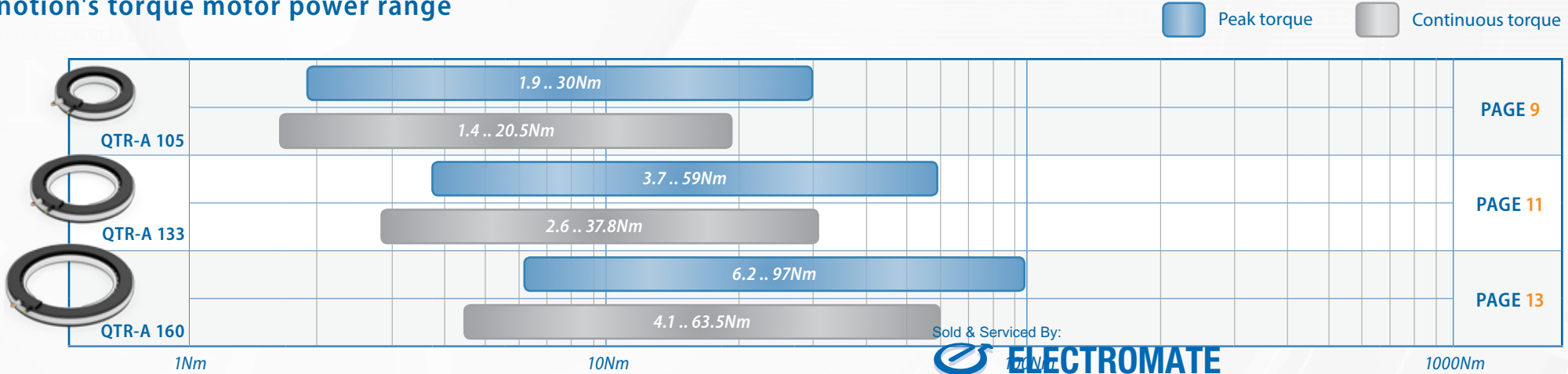

Sold & Serviced By:
ELECTROMATE

Toll Free Phone (877) SERV098
 Toll Free Fax (877) SERV099
www.electromate.com
sales@electromate.com

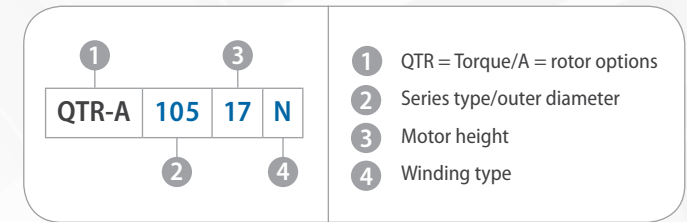

Why choose Tecnotion's Torque motor series?

Tecnotion's QTR torque motor series can find its way into many different markets, for example semiconductor, robotics, packaging, printing, machine tooling or medical application markets.

Due to the extensive motor design knowledge within Tecnotion, the QTR series are ahead in development. Compared to other torque motors, the QTR series offers a superior torque density and stands out with its small size and weight. The QTR has a low build height and larger inner diameter while offering the same or higher torque specifications compared to other torque motors. The low motor mass provides the opportunity to improve entire stage designs. Offering great opportunities to lower total cost of ownership in an application.

Tecnotion's extensive experience in coil design also reflects in the QTR thermal resistance characteristics. The QTR series offers enhanced thermal management compared to competitors. This can contribute, for instance, to motor reliability.

Finally, the QTR series also has a low cogging value like Tecnotion's iron core motor series, offering a smooth running characteristic and excellent position accuracy.

The range

The initial torque range consists of a series of three different outer diameters of 105, 133 and 160 mm for the largest motor. Each series has five build heights ranging from 17 mm up to 92 mm.



QTR-A 105 Series

Tp 1.9..30Nm Tc 1.4..20.5Nm

The QTR-A 105 is the smallest torque motor with a 105mm outer and 56mm inner diameter. This series offers a continuous torque range from 1.7 up to 19.5Nm spread over its 5 types. The largest motor in the series can attain a peak torque of 30.2Nm with a total motor mass of under 3500 gram.



QTR-A 133 Series

Tp 3.7..59Nm Tc 2.6..37.8Nm

The QTR-A 133 is the medium range of the QTR motors. It covers the torque range from 2.6 to 29.2Nm. The largest 92 mm high QTR-A-133-92 motor offers a peak torque of over 58.9Nm.



QTR-A 160 series

Tp 6.2..97Nm Tc 4.1..63.5Nm

The 160 series is the largest in diameter of the torque range. The smallest of the series, QTR-A-160-17 starts with a continuous torque of 4.4Nm. The range ends with the large QTR-A-160-92 with a continuous torque of 48.3Nm and a peak of 97.2Nm.

Sold & Serviced By:
ELECTROMATE

Toll Free Phone (877) SERV098
Toll Free Fax (877) SERV099
www.electromate.com
sales@electromate.com

Features

Tecnotion's QTR torque motor performance advantages

The direct drive technology of brushless torque motors is a perfect way to enhance productivity, accuracy, and dynamic performance of applications. The technology lowers costs, makes designs slimmer, and reduce wear and tear. Torque motors eliminate the need for mechanical transmissions like gearboxes, belts and speed reducers. Between rotor and stator there is no contact, this means no mechanical wear.

Direct drive

Higher stiffness no backlash.

Ultra thin design

The lower build height allows to build flatter axis, resulting in less tipping and settling time. Extraordinary flexibility in designing the motor in to small spaces.

Tecnotion QTR has the highest torque density in the market

More torque in a smaller packing means lowering footprint.

Low thermal resistance

Allowing good heat transfer, achieving an extremely high continuous torque when using a descent size heatsink or active cooling.

Low cogging value , low total harmonic distortion THD

For smooth motion and position accuracy in your application.

Encapsulated design

No open coil wires which can be damaged or that need to be covered up for safety reasons.

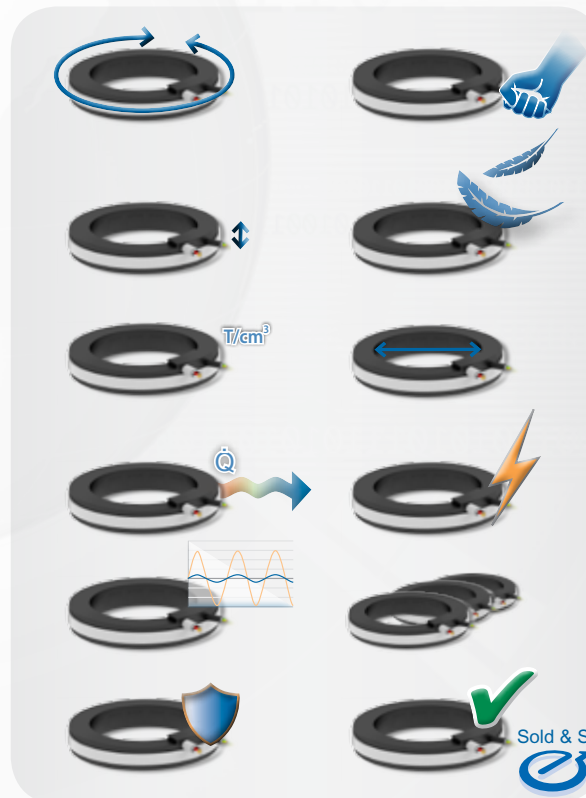

Shielded cable with strain relief

No shielding EMC issues with loose wires. No risk to damage the motor by accidentally pulling the cable.

Low stator and rotor mass

Lower masses increase the dynamics and response of the system by lowering the inertia. It hands the opportunity to improve entire stage designs! And as a result, lowering an applications cost of ownership.

Large inner diameter

Allows easy integration of a large number of cables and hoses or allows large shaft fittings.

High voltage insulated, up to 300VDC/600VDC busvoltage

Enabling the use of a wide range of servo drives, and power supplies.

Good product repeatability

All motors have specifications with extremely little variation between them.

100% QC

All products are 100% mechanically and electrically tested.



Toll Free Phone (877) SERV098
Toll Free Fax (877) SERV099
www.electromate.com
sales@electromate.com

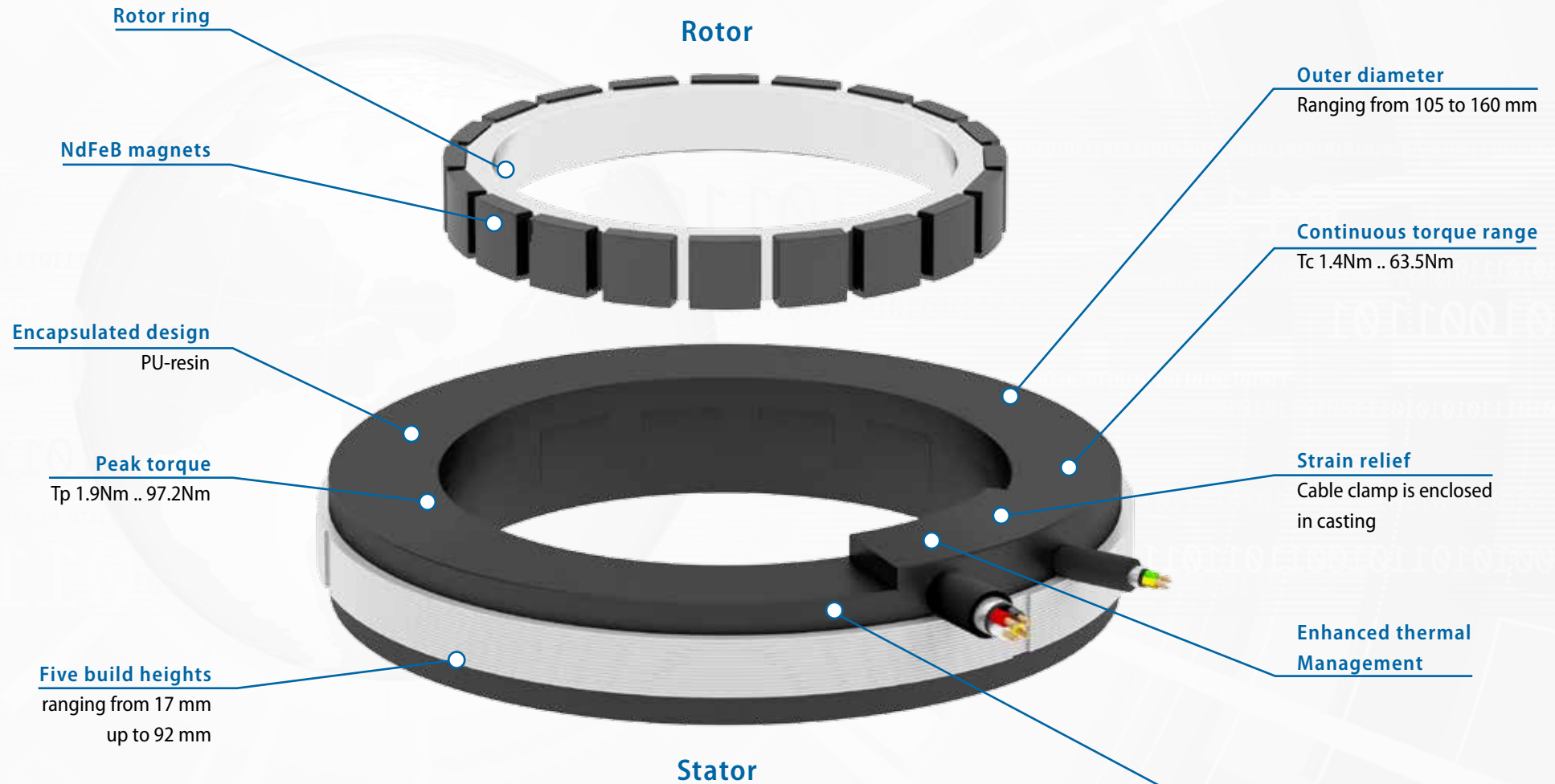

Sold & Serviced By:
 **ELECTROMATE**

Toll Free Phone (877) SERV098
Toll Free Fax (877) SERV099
www.electromate.com
sales@electromate.com

STATOR

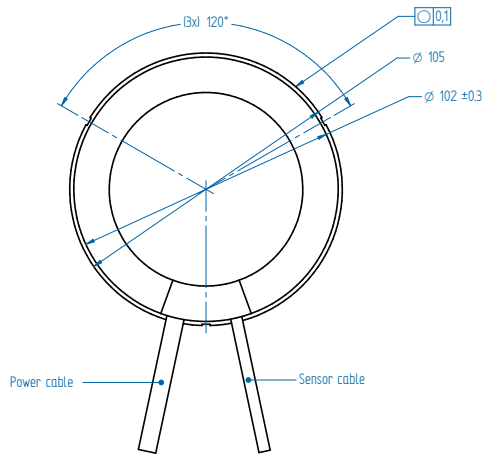

QTR-A-105-17

QTR-A-105-25

QTR-A-105-34

QTR-A-105-60

QTR-A-105-92

ROTOR

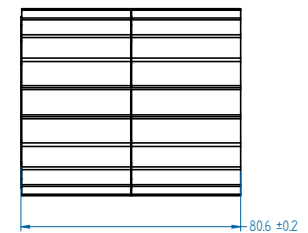
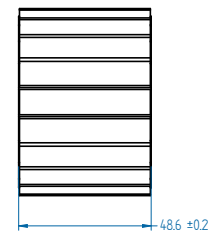
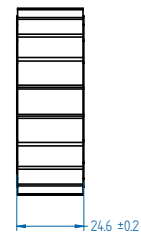
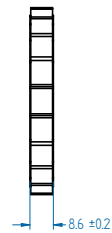
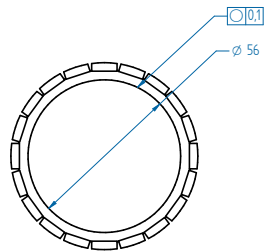

Sold & Serviced By:



Toll Free Phone (877) SERV098

Toll Free Fax (877) SERV099

www.electromate.com

sales@electromate.com

QTR 105

QTR 133

QTR 160

	Parameter	Remarks	Symbol	Unit	QTR-A-105-17	QTR-A-105-25	QTR-A-105-34	QTR-A-105-60	QTR-A-105-92
Performance	Winding type				N	N	N	N	N
	Motortype. max voltage ph-ph				3-phase synchronous frameless Torque. 230V _{ac rms} (300V _{dc})			420V _{ac rms} (600V _{dc})	
	Ultimate Torque @ 20°C/s increase	magnet @ 25°C	T _u	Nm	2.9	6.1	10.6	28.4	47.4
	Peak Torque @ 6°C/s increase	magnet @ 25°C	T _p	Nm	1.9	3.9	6.7	18.1	30.2
	Continuous Torque	coil@100°C	T _c	Nm	1.4	3.2	5.4	12	20.5
	Maximum speed*	@Tc	n _{max}	rpm	6918	3579	1866	1386	773
	Motor Torque constant	up to I _c	K _t	Nm/A	0.297	0.595	1.07	2.86	4.76
	Motor constant	coils @ 25°C	K _m	(Nm) ² /W	0.021	0.061	0.127	0.40	0.73
Electrical	Ultimate Current	magnet @ 70°C	I _u	A	13.8	13.8	13.3	13.5	13.5
	Peak Current	magnet @ 25°C	I _p	A	7.56	7.56	7.31	7.37	7.37
	Maximum Continuous Current**	coils @ 100°C	I _c	A	4.64	5.34	5.05	4.19	4.3
	Back EMF Phase-Phase _{RMS}		K _e	V/krpm	18	36	65	173	288
	Coil Resistance per Phase	coils @ 25°C ex. cable	R	Ω	1.38	1.93	3.02	6.84	10.4
	Coil induction per Phase	l < 0.6 lp	L	mH	2.58	4.05	7.93	25.3	40.4
	Electrical Time Constant	coils @ 25°C	τ _e	ms	1.9	2.1	2.6	3.7	3.9
	Poles		N _{mgn}	nr	20	20	20	20	20
Thermal	Continuous Power Loss	coils @ 100°C	P _c	W	115	214	300	469	750
	Thermal Resistance***	coils to mount. sfc.	R _{th}	°C/W	0.65	0.35	0.25	0.16	0.1
	Thermal Time Constant		τ _{th}	s	21	16	17	25	24
	Temperature Cut-off / Sensor				PTC 1kΩ / KTY83-122				
Mechanical	Stator OD		OD _s	mm	105	105	105	105	105
	Rotor ID		ID _R	mm	56	56	56	56	56
	Motor Height		H _{motor}	mm	17	25	34	60	92
	Lamination Stack Height		H _{arm}	mm	8	16	24	48	80
	Rotor Inertia		J _R	kg*m ²	7.7E-05	1.5E-04	2.2E-04	4.3E-04	7.1E-04
	Stator Mass	ex. cables	M _s	g	299	472	746	1476	2366
	Rotor Mass		M _R	g	79	146	218	433	719
	Total Mass	ex. cables	M _T	g	378	618	964	1909	3085
	Cable Mass	all cables	m	g	63	63	63	95	95
	Cable Type (Power)	length 0.5 m	d	mm (AWG)	6.5 (20)			9.6 (18)	
Cable Type (Sensor)	length 0.5 m	d	mm (AWG)	4.3 (26)					



QTR-A-105 Stator and rotor shown with a height of 17 mm

All specifications ±0.0%

* Actual values depend on bus voltage. Please check the T/n diagram in our simulation tool.

** These values are only applicable when the mounting surface is at 20°C and the motor is driven at maximum continuous current. If these values differ in your application, please check our simulation tool.

*** R_{th} based on radial mounting of rotor lamination stack.

Sold & Serviced By:



Toll Free Phone (877) SERV098
Toll Free Fax (877) SERV099
www.electromate.com
sales@electromate.com

STATOR

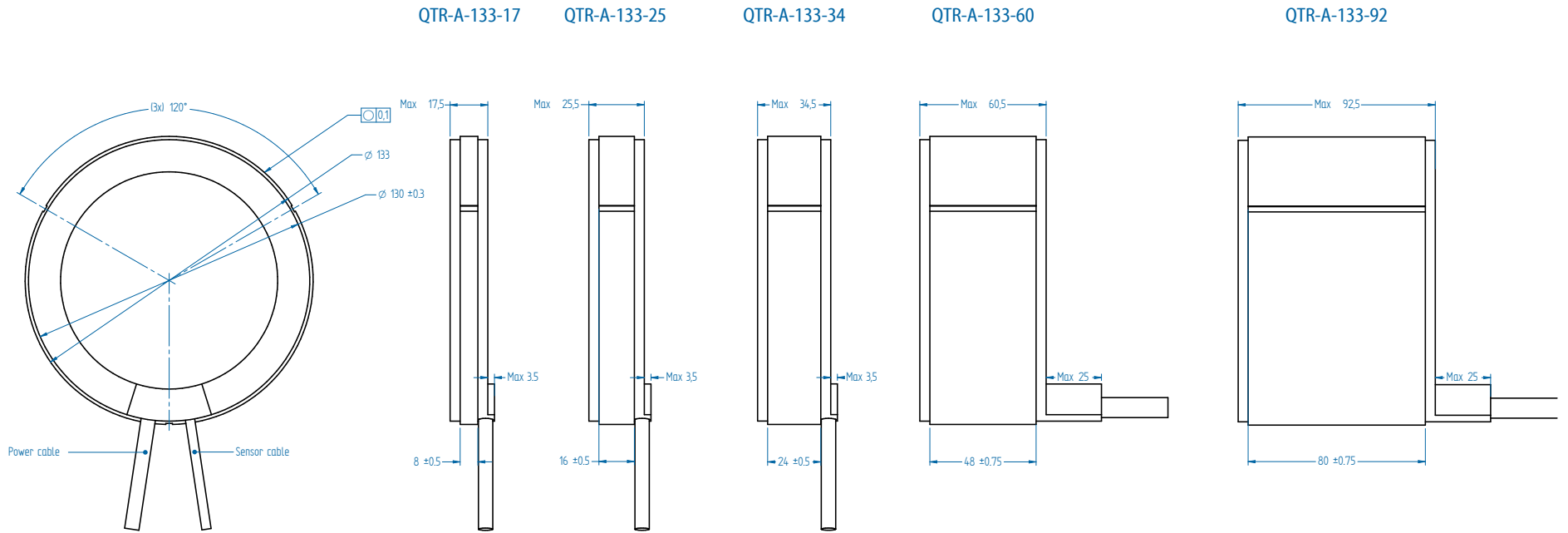

ROTOR

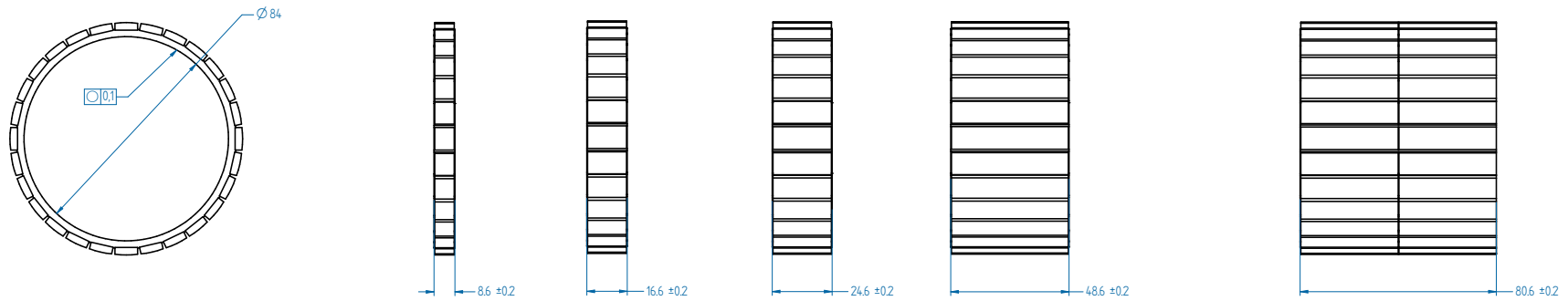

Sold & Serviced By:



Toll Free Phone (877) SERV098
 Toll Free Fax (877) SERV099
www.electromate.com
sales@electromate.com

Parameter	Remarks	Symbol	Unit	QTR-A-133-17	QTR-A-133-25	QTR-A-133-34	QTR-A-133-60	QTR-A-133-92
Winding type				N	N	N	N	N
Motor type. max voltage ph-ph				3-phase synchronous frameless Torque. 230V _{ac rms} (300V _{dc})			420V _{ac rms} (600V _{dc})	
Ultimate Torque @ 20°C/s increase	magnet @ 25°C	T _u	Nm	5.60	11.9	20.6	55.5	92.5
Peak Torque @ 6°C/s increase	magnet @ 25°C	T _p	Nm	3.77	7.5	13.1	35.3	58.9
Continuous Torque	coil@100°C	T _c	Nm	2.57	5.86	10	21.9	37.8
Maximum speed*	@Tc	n _{max}	rpm	3477	1779	910	684	363
Motor Torque constant	Up to I _c	K _t	Nm/A	0.58	1.16	2.09	5.57	9.28
Motor constant	coils @ 25°C	K _m	(Nm) ² /W	0.058	0.167	0.344	1.08	1.98
Ultimate Current	magnet @ 70°C	I _u	A	13.8	13.8	13.3	13.5	13.5
Peak Current	magnet @ 25°C	I _p	A	7.56	7.56	7.31	7.37	7.37
Maximum Continuous Current**	coils @ 100°C	I _c	A	4.43	5.05	4.77	3.93	4.07
Back EMF Phase-Phase _{RMS}		K _e	V/krpm	35	70	126	337	561
Coil Resistance per Phase	coils @ 25°C ex. cable	R	Ω	1.93	2.70	4.23	9.58	14.5
Coil induction per Phase	l < 0.6 lp	L	mH	3.74	5.87	11.5	36.6	58.4
Electrical Time Constant	coils @ 25°C	τ _e	ms	1.94	2.18	2.72	3.83	4.02
Poles		N _{mgn}	nr	28	28	28	28	28
Continuous Power Loss	coils @ 100°C	P _c	W	147	268	375	577	938
Thermal Resistance***	coils to mount. sfc.	R _{th}	°C/W	0.51	0.28	0.20	0.13	0.08
Thermal Time Constant		τ _{th}	s	23	18	19	29	27
Temperature Cut-off / Sensor				PTC 1kΩ / KTY83-122				
Stator OD		OD _s	mm	133	133	133	133	133
Rotor ID		ID _R	mm	84	84	84	84	84
Motor Height		H _{motor}	mm	17	25	34	60	92
Lamination Stack Height		H _{arm}	mm	8	16	24	48	80
Rotor Inertia		J _R	kg*m ²	2.1E-04	4.2E-04	6.2E-04	1.2E-03	2.1E-03
Stator Mass	ex. cables	M _s	g	414	717	1037	2090	3355
Rotor Mass		M _R	g	106	208	309	613	1020
Total Mass	ex. cables	M _T	g	520	925	1346	2703	4375
Cable Mass	all cables	m	g	63	63	63	95	95
Cable Type (Power)	length 0.5 m	d	mm (AWG)	6.5 (20)			9.6 (18)	
Cable Type (Sensor)	length 0.5 m	d	mm (AWG)	4.3 (26)				



QTR-A-133 Stator and rotor shown with a height of 17 mm

All specifications ±0%

* Actual values depend on bus voltage. Please check the T/n diagram in our simulation tool.

** These values are only applicable when the mounting surface is at 20°C and the motor is driven at maximum continuous current. If these values differ in your application, please check our simulation tool.

*** R_{th} based on radial mounting of rotor lamination stack.

Sold & Serviced By:



Toll Free Phone (877) SERV098
 Toll Free Fax (877) SERV099
www.electromate.com
sales@electromate.com

STATOR

ROTOR

QTR-A-160-17

QTR-A-160-25

QTR-A-160-34

QTR-A-160-60

QTR-A-160-92

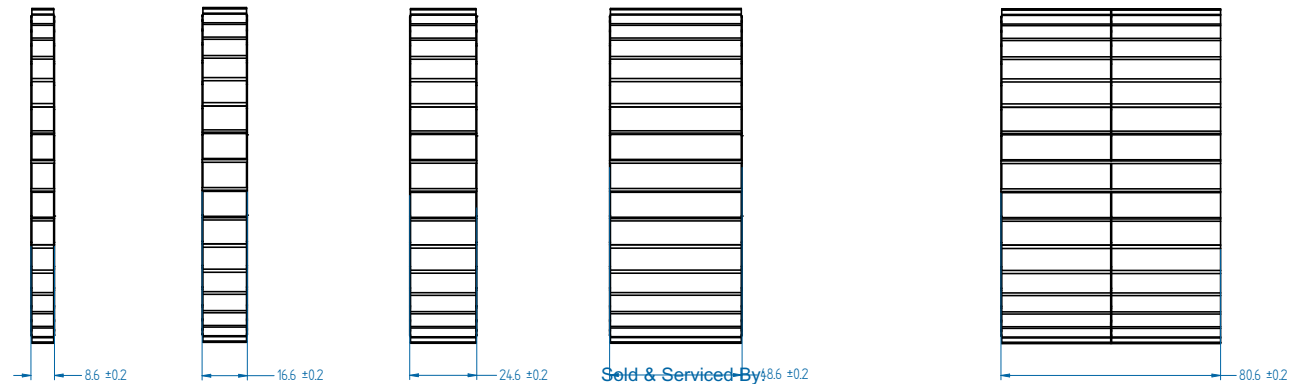
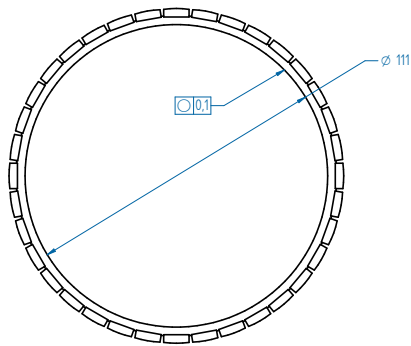
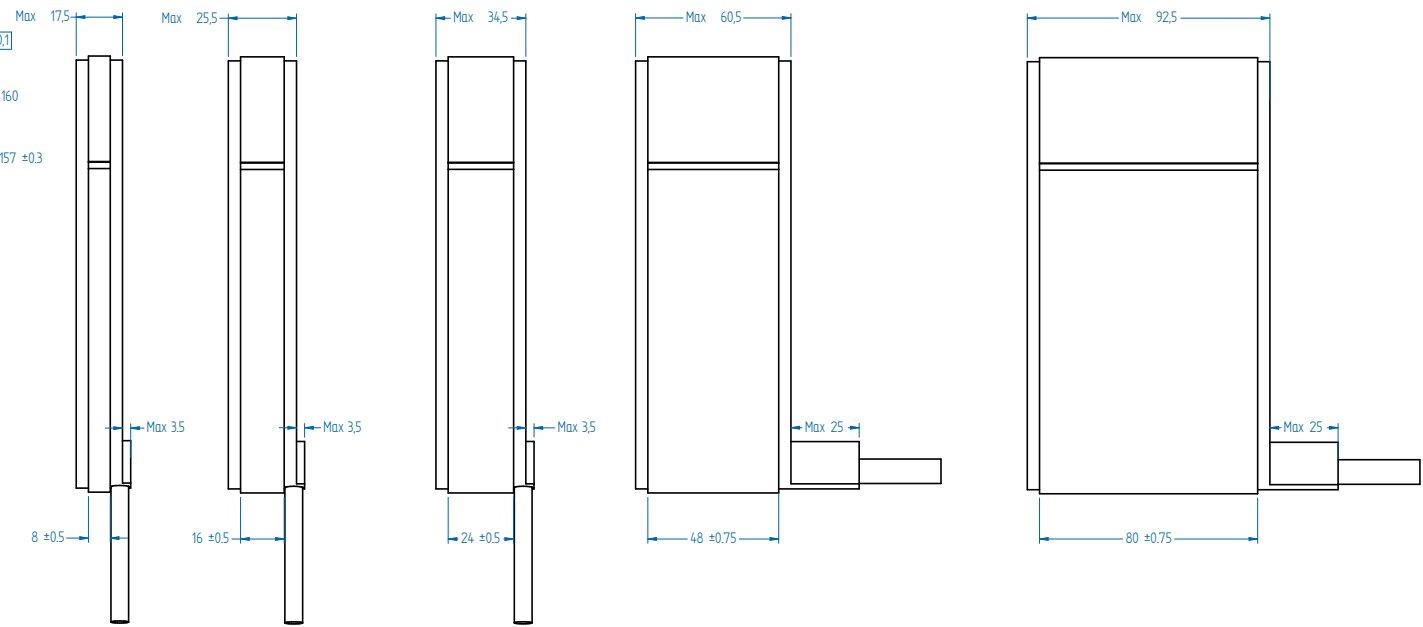
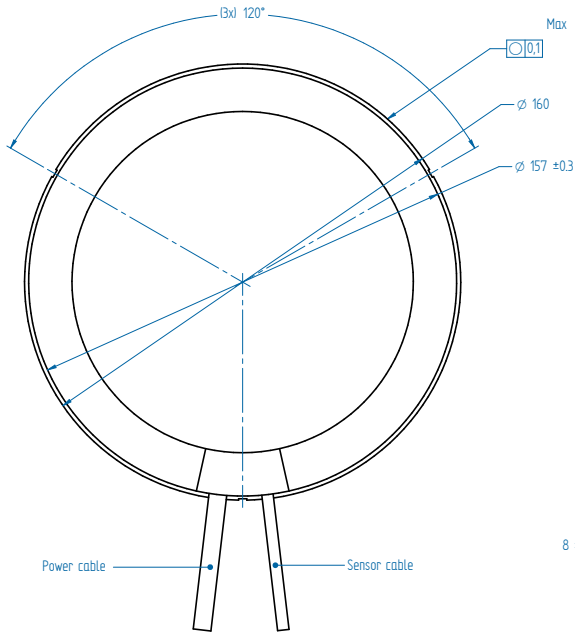

Sold & Serviced By **ELECTROMATE**

Toll Free Phone (877) SERV098
Toll Free Fax (877) SERV099
www.electromate.com
sales@electromate.com

QTR 105 QTR 133 QTR 160

Parameter	Remarks	Symbol	Unit	QTR-A-160-17	QTR-A-160-25	QTR-A-160-34	QTR-A-160-60	QTR-A-160-92
Performance								
Winding type				N	N	N	N	N
Motor type, max voltage ph-ph				3-phase synchronous frameless Torque, 230V _{ac rms} (300V)			420V _{ac rms} (600V _{dc})	
Ultimate Torque @ 20°C/s increase	magnet @ 25°C	T _u	Nm	9.26	19.6	34.1	91.6	152.7
Peak Torque @ 6°C/s increase	magnet @ 25°C	T _p	Nm	6.23	12.5	21.7	58.3	97.2
Continuous Torque	coil@100°C	T _c	Nm	4.08	9.42	15.7	36.3	63.5
Maximum speed*	@Tc	n _{max}	rpm	2095	1042	526	385	190
Motor Torque constant	Up to I _c	K _t	Nm/A	0.96	1.92	3.45	9.20	15.33
Motor constant	coils @ 25°C	K _m	(Nm) ² /W	0.124	0.353	0.728	2.29	4.19
Electrical								
Ultimate Current	magnet @ 70°C	I _u	A	13.8	13.8	13.3	13.5	13.5
Peak Current	magnet @ 25°C	I _p	A	7.6	7.6	7.3	7.4	7.4
Maximum Continuous Current**	coils @ 100°C	I _c	A	4.26	4.91	4.56	3.95	4.14
Back EMF Phase-Phase _{RMS}		K _e	V/krpm	58	116	209	556	927
Coil Resistance per Phase	coils @ 25°C ex. cable	R	Ω	2.47	3.47	5.45	12.3	18.7
Coil induction per Phase	l < 0.6 I _p	L	mH	4.89	7.68	15.0	47.9	76.1
Electrical Time Constant	coils @ 25°C	τ _e	ms	1.98	2.21	2.75	3.88	4.07
Poles		N _{mgn}	nr	36	36	36	36	36
Thermal								
Continuous Power Loss	coils @ 100°C	P _c	W	174	326	441	750	1250
Thermal Resistance***	coils to mount. sfc.	R _{th}	°C/W	0.43	0.23	0.17	0.1	0.06
Thermal Time Constant		τ _{th}	s	25	19	21	29	26
Temperature Cut-off / Sensor				PTC 1kΩ / KTY83-122				
Mechanical								
Stator OD		OD _s	mm	160	160	160	160	160
Rotor ID		ID _R	mm	111	111	111	111	111
Motor Height		H _{motor}	mm	17	25	34	60	92
Lamination Stack height		H _{arm}	mm	8	16	24	48	80
Rotor Inertia		J _R	kg*m ²	4.7E-04	9.2E-04	1.4E-03	2.6E-03	4.5E-03
Stator Mass	ex. cables	M _S	g	527	875	1212	2555	4096
Rotor Mass		M _R	g	138	269	401	754	1321
Total Mass	ex. cables	M _T	g	665	1144	1613	3309	5417
Cable Mass	all cables	m	g	63	63	63	95	95
Cable Type (Power)	length 0.5 m	d	mm (AWG)	6.5 (20)			9.6 (18)	
Cable Type (Sensor)	length 0.5 m	d	mm (AWG)	4.3 (26)				



QTR-A-160 Stator and rotor shown with a height of 17 mm

All specifications ±0.0%

* Actual values depend on bus voltage. Please check the T/n diagram in our simulation tool.

** These values are only applicable when the mounting surface is at 20°C and the motor is driven at maximum continuous current. If these values differ in your application, please check our simulation tool.

*** R_{th} based on radial mounting of rotor lamination stack.

Sold & Serviced By:



Toll Free Phone (877) SERV098
 Toll Free Fax (877) SERV099
 www.electromate.com
 sales@electromate.com

Additional products

To download our linear motor simulation tool, 3D & CAD files, installation manuals, product specifications and more, visit our website at:

www.tecnotion.com

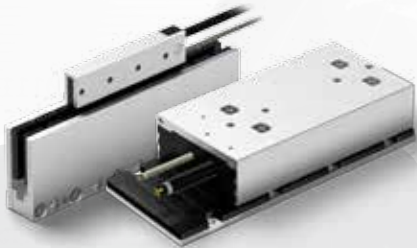

Product Series

Iron Core & Ironless Motor Series

Tecnotions linear motor series rely on 25 years of linear motor development experience. All motors excel in their force density ratings. They offer continuous force in a range of 36 Newton to 3000 Newton in a surprisingly small package.

Tecnotion can provide linear solutions for most applications which require a strong iron core linear motor or a highly dynamic ironless type linear motor.



Vacuum Series

Outgassing down to 10⁻⁸ mbar

Many years of experience is used in designing and building vacuum coils and magnets. Tecnotion can supply any vacuum linear motor that can match even the strictest vacuum requirements, for instance in the semiconductor industry.

Our vacuum rated ironless linear motors are a specifically designed coil units and magnet yokes for use in high- vacuum, down to 10⁻⁸ mBar.

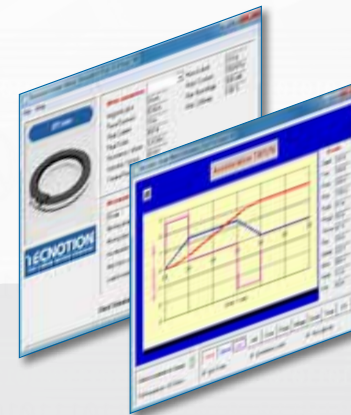

Simulation Tool

Analyze your application

Save precious time by using our FREE Torque motor simulation tool. Our specialized software helps you find the best motor for the application and generate reports within seconds, without having to make time consuming calculations by hand.

The tool will provide you with diagrams for position, velocity, acceleration, jerk, torque, power, voltage, current, temperature, torque vs. velocity and more.



Custom Linear Motors

Motor solutions

Besides the standard catalogue items we offer custom linear motor solutions. Some examples: custom windings, cable confection and vacuum motors for transport and positioning in vacuum.

Besides this Tecnotion offers moving magnet motors and linear actuators, completely designed toward needs. For more information please contact Tecnotion.



Toll Free Phone (877) SERV098
Toll Free Fax (877) SERV099
www.electromate.com
sales@electromate.com