

## Specifications

Specifications	Units	PTM-24M	PTM-24MG (gearhead)							
Rated Voltage	V	24/100 ±10%								
Frequency	Hz	50/60								
Rated Current	mA	16/17								
Revolutions @ 50Hz	rpm	250/300	1/3	1/2	1	2	5	10	30	60
Rotating Direction		Dual Direction (CC/CCW)								
Torque @ 60 Hz	mN·m	12/12.5	600	600	600	500	380	220	90	45
Temperature Rise	°K	55								
Operating Temp. Range	°C	-10 to +50								
Dielectric Strength	V	1500Vac for 10 seconds	1500Vac for 10 seconds							
Weight	g	80	112							
Capacitor	µF	3.9	0.23							

Magnet type: Anisotropic

## Torque Characteristics

Model	PTM-24M			
Speed	Torque (mN·m)		Gear Ratio	
rpm	50Hz	60Hz	50Hz	60Hz
60	--	40	--	1/5
30	--	80	--	1/10
20	--	96	--	1/15
10	150	190	1/25	1/30
5	245	300*	1/50	1/60
4	--	300*	--	1/75
3	--	300*	--	1/100
2	400	600*	1/125	1/150
1	--	600*	--	1/300

\*-Values regulated by normal gear strength. Do not apply any load exceeding the normal gear strength.

## Geared Models

### PTM-24MG

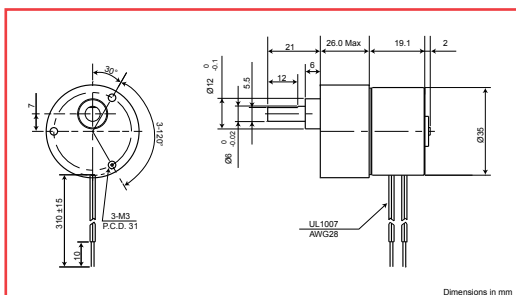

Sold & Serviced By:



Toll Free Phone (877) SERV098

Toll Free Fax (877) SERV099

www.electromate.com

sales@electromate.com