



SL **12** - **SS** - **PD** x **105.375**

Shafting _____

- SL** - Class L diameter tolerance
- SS** - Class S diameter tolerance
- SN** - Class N diameter tolerance

Shaft Diameter _____

- 4** - 0.250 inch diameter
- 6** - 0.375 inch diameter
- 8** - 0.500 inch diameter
- 10** - 0.625 inch diameter
- 12** - 0.750 inch diameter
- 16** - 1.000 inch diameter
- 20** - 1.250 inch diameter
- 24** - 1.500 inch diameter
- 32** - 2.000 inch diameter

Shaft Material _____

- 1060 Steel
- SS** - 440C Stainless Steel (not available in class N)
- CR** - Chrome Plated 1060 Steel

Pre-Drilled _____

- No mounting hole pattern
- PD** - pre-drilled hole pattern

Overall Length _____

xxx.xxx - inches for all series

Specifications: SL, SS & SN Inch Precision Shafting

Shaft Straightness⁽¹⁾	0.001/0.002 in/ft, cumulative				
Shaft Type	1060 Steel or 440C Stainless steel (only with L & S tolerance)				
Shaft Roundness	0.000080 inches				
Shaft Chamfer	For 0.25 - 0.75 inch dia. : 0.03 inch x 45°, For 1.00 - 2.00 inch dia. : 0.06 inch x 45°				
Surface Finish	8 - 12 R _a microinch				
Diameter Tolerance	Nominal Shaft Diameter (inches)	Class L Diameter Tolerance (inches)	Class S Diameter Tolerance (inches)	Class N Diameter Tolerance (inches)	Minimum Hardness Depth (inches)
Hardness Depth	0.250	.2495 / .2490	.2490 / .2485	.2500 / .2498	0.040
	0.375	.3745 / .3740	.3740 / .3735	.3750 / .3748	0.040
	0.500	.4995 / .4990	.4990 / .4985	.5000 / .4998	0.040
	0.625	.6245 / .6240	.6240 / .6235	.6250 / .6248	0.040
	0.750	.7495 / .7490	.7490 / .7485	.7500 / .7498	0.060
	1.000	.9995 / .9990	.9990 / .9985	1.0000 / .9998	0.080
	1.250	1.2495 / 1.2490	1.2490 / 1.2485	1.2500 / 1.2498	0.080
	1.500	1.4994 / 1.4989	1.4989 / 1.4984	1.5000 / 1.4997	0.080
	2.000	1.9994 / 1.9987	1.9987 / 1.9980	2.0000 / 1.9997	0.100

Footnotes:

(1) Straightness of .0005/.001 in/ft cumulative is available. Contact the factory.

Dimensions & Specifications: SL, SS & SN Inch Precision Shafting

Model Number	Nominal Shaft Diameter (inches)	Maximum Length				Shaft Weight (lbs/in)	
		Class L -SS (inches)		Class S -SS (inches)			Class N (inches)
Sx4	0.250	96	144	96	144	96	0.014
Sx6	0.375	172	154	172	154	172	0.031
Sx8	0.500	184	154	184	154	184	0.055
Sx10	0.625	184	154	184	154	184	0.086
Sx12	0.750	184	154	184	154	184	0.125
Sx16	1.000	184	154	184	154	184	0.222
Sx20	1.250	184	154	184	154	184	0.348
Sx24	1.500	184	154	184	154	184	0.500
Sx32	2.000	184	154	184	154	184	0.890

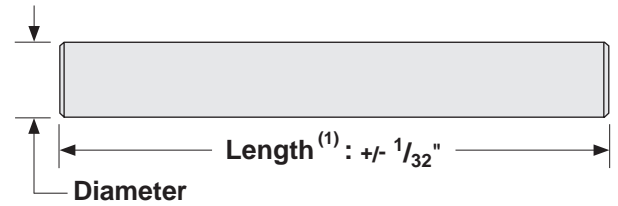

Dimensions & Specifications: SL-PD Inch Precision Shafting

Model Number	Nominal Shaft Diameter (inches)	Maximum Length (inches)		Pre-Drilled Holes (inches)			Shaft Weight (lbs/in)
		-SS (inches)		A +/- .016	B	G	
SL8-PD	0.500	172	154	2.00	4.00	#6-32	0.055
SL10-PD	0.625	184	154	2.00	4.00	#8-32	0.086
SL12-PD	0.750	184	154	3.00	6.00	#10-32	0.125
SL16-PD	1.000	184	154	3.00	6.00	1/4-20	0.222
SL20-PD	1.250	184	154	3.00	6.00	5/16-18	0.348
SL24-PD	1.500	184	154	4.00	8.00	3/8-16	0.500
SL32-PD	2.000	184	154	4.00	8.00	1/2-13	0.890

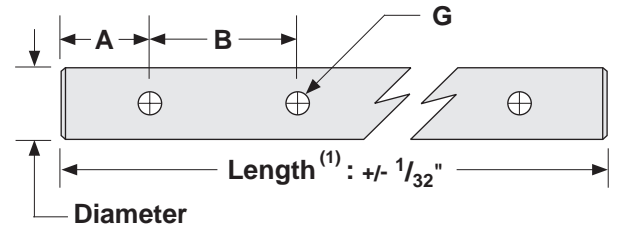

Footnotes:

(1) Length tolerance for 2" diameter shafting is +/- 1/16 inches. Tighter tolerance available. Contact the factory.



SM 12 - CR x 105.375

Shafting _____

SM - Metric diameter

Shaft Diameter _____

- 8** - 8 mm diameter
- 10** - 10 mm diameter
- 12** - 12 mm diameter
- 16** - 16 mm diameter
- 20** - 20 mm diameter
- 25** - 25 mm diameter
- 30** - 30 mm diameter
- 40** - 40 mm diameter
- 50** - 50 mm diameter

Shaft Material _____

- 1060 Steel
- CR** - Chrome Plated 1060 Steel

Overall Length _____

xxx.xxx - inches for all series

Specifications: **SM** Metric Precision Shafting

Shaft Straightness	0,0254/0,0508 mm/300 mm - cumulative																														
Shaft Type	1060 Steel																														
Shaft Roundness	0,0020 mm																														
Shaft Chamfer	For 8 - 20 mm dia. : 0,762 mm x 45°, For 25 - 50 mm dia. : 1,524 mm inch x 45°																														
Surface Finish	8 - 12 R _a microinch																														
Diameter Tolerance	<table border="1" style="width: 100%; border-collapse: collapse;"> <thead> <tr> <th style="text-align: center;">Nominal Shaft Diameter (mm)</th> <th style="text-align: center;">Diameter Tolerance (mm)</th> <th style="text-align: center;">Minimum Hardness Depth (mm)</th> </tr> </thead> <tbody> <tr><td style="text-align: center;">8</td><td style="text-align: center;">8,00 / 7,99</td><td style="text-align: center;">1,02</td></tr> <tr><td style="text-align: center;">10</td><td style="text-align: center;">10,00 / 9,99</td><td style="text-align: center;">1,02</td></tr> <tr><td style="text-align: center;">12</td><td style="text-align: center;">12,00 / 11,99</td><td style="text-align: center;">1,52</td></tr> <tr><td style="text-align: center;">16</td><td style="text-align: center;">16,00 / 15,99</td><td style="text-align: center;">1,52</td></tr> <tr><td style="text-align: center;">20</td><td style="text-align: center;">20,00 / 19,99</td><td style="text-align: center;">1,52</td></tr> <tr><td style="text-align: center;">25</td><td style="text-align: center;">25,00 / 24,99</td><td style="text-align: center;">2,03</td></tr> <tr><td style="text-align: center;">30</td><td style="text-align: center;">30,00 / 29,99</td><td style="text-align: center;">2,03</td></tr> <tr><td style="text-align: center;">40</td><td style="text-align: center;">40,00 / 39,99</td><td style="text-align: center;">2,03</td></tr> <tr><td style="text-align: center;">50</td><td style="text-align: center;">50,00 / 49,98</td><td style="text-align: center;">2,54</td></tr> </tbody> </table>	Nominal Shaft Diameter (mm)	Diameter Tolerance (mm)	Minimum Hardness Depth (mm)	8	8,00 / 7,99	1,02	10	10,00 / 9,99	1,02	12	12,00 / 11,99	1,52	16	16,00 / 15,99	1,52	20	20,00 / 19,99	1,52	25	25,00 / 24,99	2,03	30	30,00 / 29,99	2,03	40	40,00 / 39,99	2,03	50	50,00 / 49,98	2,54
Nominal Shaft Diameter (mm)		Diameter Tolerance (mm)	Minimum Hardness Depth (mm)																												
8		8,00 / 7,99	1,02																												
10		10,00 / 9,99	1,02																												
12		12,00 / 11,99	1,52																												
16		16,00 / 15,99	1,52																												
20		20,00 / 19,99	1,52																												
25		25,00 / 24,99	2,03																												
30		30,00 / 29,99	2,03																												
40	40,00 / 39,99	2,03																													
50	50,00 / 49,98	2,54																													
Hardness Depth																															

Dimensions & Specifications: **SM** Metric Precision Shafting

Model Number	Nominal Shaft Diameter (mm)	Maximum Length inches (mm)	Shaft Weight (lbs/in)
SM8	8	172 (4368,8)	0.022
SM10	10	172 (4368,8)	0.038
SM12	12	184 (4673,6)	0.050
SM16	16	184 (4673,6)	0.088
SM20	20	184 (4673,6)	0.138
SM25	25	184 (4673,6)	0.216
SM30	30	184 (4673,6)	0.311
SM40	40	184 (4673,6)	0.553
SM50	50	184 (4673,6)	0.864

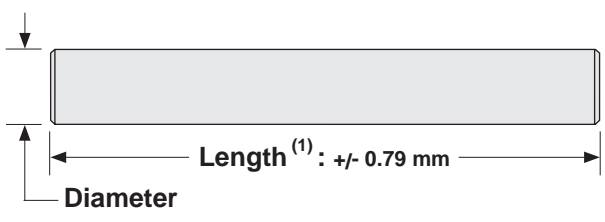

(1) Tighter tolerance available. Contact the factory.