

750-30-0000

Model Number: DB1205D-0

Brushless DC motor control technology is ideal if you're looking for quiet motor operation, long life expectancy for both drive and motor and high efficiency operation with low power loss. This design is proven to be the first choice for tougher applications. This control commutates power into standard 3-phase brushless DC motors. Their source of power is single phase 115 VAC and rates up to 3.1 amps of continuous current to the motor. This control is offered in both open and closed loop versions for BLDC motors with sensor spacings of 60 and 120 degrees.

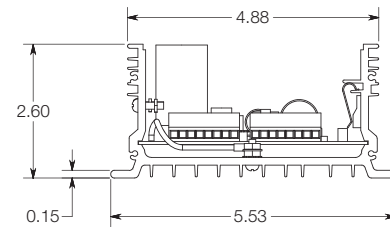
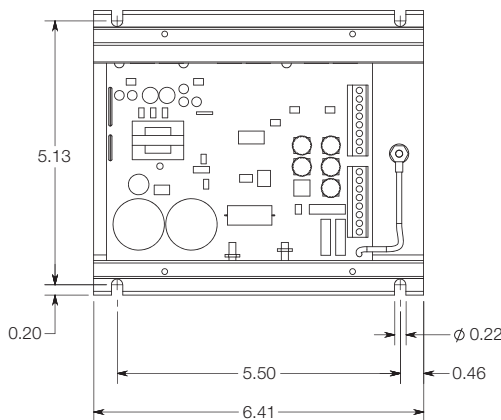

Enclosure type	Power				Speed Control			
	Supply Voltage (V)	Motor Voltage (V)	Current (A)		Closed loop	Speed pot.	DC signal	Digital control
			Cont.	Peak				
Chassis	115 VAC	163 VDC	3.1	4.7	x	x	0-20V	—

Units measured in inches.

Line voltage source power	Internal source power LED (green)	Simple to operate
Closed-loop speed control	Internal fault LED (red)	Speed regulation: ± 1/2% base speed
Quiet 17 kHz PWM switching	Voltage follower input	Speed range: 50:1
IGBT power devices	5k Ω speed pot kit	Length: 6.41 in.
Run/stop output indicator	+5 VDC supply for motor halls	Width: 5.53 in.
Forward/reverse	Temperature: -10° to 40° C	Height: 2.60 in.

Features: acceleration, deceleration, brake, inhibit

Sold & Serviced By:

 **ELECTROMATE**

Toll Free Phone (877) SERV098
www.electromate.com
sales@electromate.com

BRUSHLESS DC

750-30-0001

Model Number: DB1205D-4X

Brushless DC motor control technology is ideal if you're looking for quiet motor operation, long life expectancy for both drive and motor and high efficiency operation with low power loss. This design is proven to be the first choice for tougher applications. This control commutates power into standard 3-phase brushless DC motors. Their source of power is single phase 115 VAC and rates up to 3.1 amps of continuous current to the motor. This control is offered in both open and closed loop versions for BLDC motors with sensor spacings of 60 and 120 degrees.

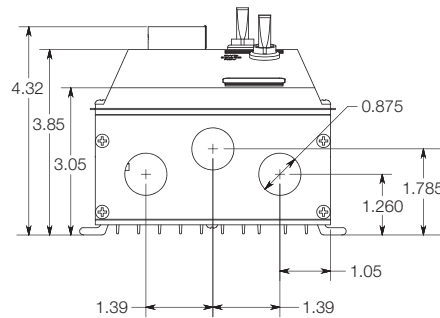
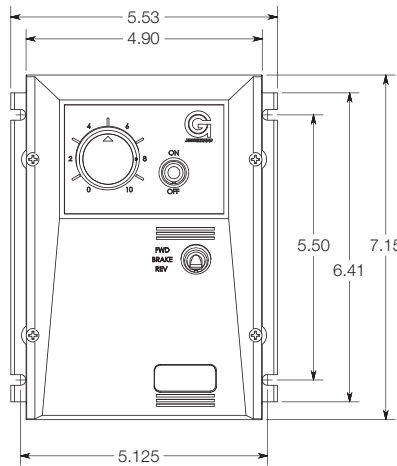

Enclosure type	Power				Speed Control			
	Supply Voltage (V)	Motor Voltage (V)	Current (A)		Closed loop	Speed pot.	DC signal	Digital control
			Cont.	Peak				
NEMA 4X	115 VAC	163 VDC	3.1	4.7	x	x	0-20V	—

Units measured in inches.

Line voltage source power	Internal source power LED (green)	Simple to operate
Closed-loop speed control	Internal fault LED (red)	Speed regulation: $\pm 1/2\%$ base speed
Quiet 17 kHz PWM switching	Voltage follower input	Speed range: 50:1
IGBT power devices	5k Ω speed pot kit	Length: 7.15 in.
Run/stop output indicator	+5 VDC supply for motor halls	Width: 5.53 in.
Forward/reverse	Temperature: -10° to 40° C	Height: 4.33 in.
Features: acceleration, deceleration, brake, inhibit		

750-30-0002

Model Number: DB1110D-0

Brushless DC motor control technology is ideal if you're looking for quiet motor operation, long life expectancy for both drive and motor and high efficiency operation with low power loss. This proven design is the first choice for tougher applications. This control is ideal when looking for high speed and quiet operation without the wear of brushes. It provides variable speed operations for larger brushless DC motors and is compact and energy efficient. When used for OEM applications, these controls have a fixed speed setting and may be provided with a pluggable connector.

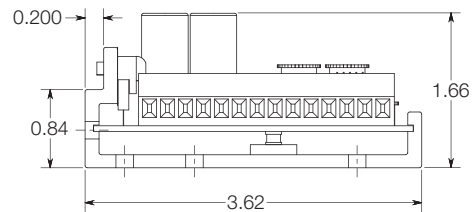
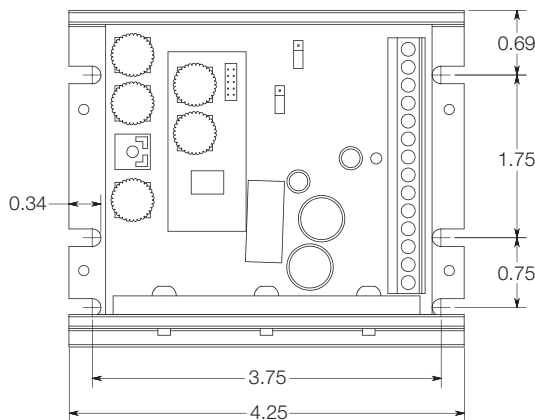

Enclosure type	Power				Speed Control			
	Supply Voltage (V)	Motor Voltage (V)	Current (A)		Closed loop	Speed pot.	DC signal	Digital control
			Cont.	Peak				
Chassis	12-48 VDC	12-48 VDC	7.5	11.3	x	x	0-5V	—

Units measured in inches.

Closed-loop speed control

Quiet 15 kHz PWM switching

MOSFET power devices

5k Ω speed pot kit

Forward/reverse control

Anodized chassis mount heatsink

Internal supply for motor

Hall-effect sensors

Simple to operate

Features: acceleration,

Speed regulation: $\pm 1/2\%$ base speed

Speed range: 60:1

Length: 4.25 in.

Width: 3.62 in.

Height: 1.30 in.

BRUSHLESS DC

750-30-0003

Model Number: DB1110D-4X

Brushless DC motor control technology is ideal if you're looking for quiet motor operation, long life expectancy for both drive and motor and high efficiency operation with low power loss. This proven design is the first choice for tougher applications. This control is ideal when looking for high speed and quiet operation without the wear of brushes. It provides variable speed operations for larger brushless DC motors and is compact and energy efficient. When used for OEM applications, these controls have a fixed speed setting and may be provided with a pluggable connector.

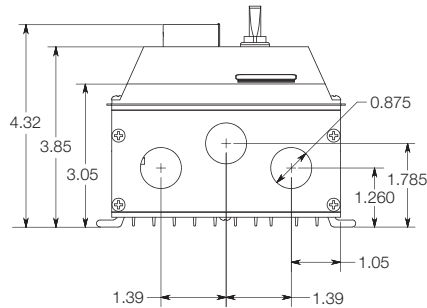
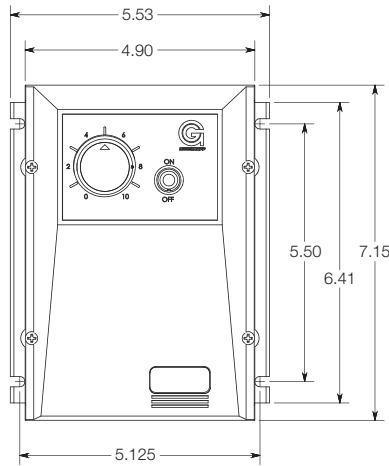

Enclosure type	Power				Speed Control			
	Supply Voltage (V)	Motor Voltage (V)	Current (A)		Closed loop	Speed pot.	DC signal	Digital control
			Cont.	Peak				
NEMA 4X	12-48 VDC	12-48 VDC	7.5	11.3	x	x	0-5V	—

Units measured in inches.

Closed-loop speed control

Quiet 15 kHz PWM switching

MOSFET power devices

5k Ω speed pot kit

Forward/reverse control

Anodized chassis mount heatsink

Internal supply for motor

Hall-effect sensors

Simple to operate

Features: acceleration, deceleration, brake, inhibit

Speed regulation: $\pm 1/2\%$ base speed

Speed range: 60:1

Length: 7.15 in.

Width: 5.53 in.

Height: 4.32 in.

Sold & Serviced By:



Toll Free Phone (877) SERV098

www.electromate.com

sales@electromate.com

750-30-0004

Model Number: DB1120D-0

Brushless DC motor control technology is ideal if you're looking for quiet motor operation, long life expectancy for both drive and motor and high efficiency operation with low power loss. Its proven design is the first choice for tougher applications. This control provides variable speed operations for larger brushless DC motors and is compact and energy efficient. It is also able to produce speed commutation and control for motors with continuous ratings up to 1000 watts. This control is ideal when looking for high speed and quiet operation without the wear of brushes.

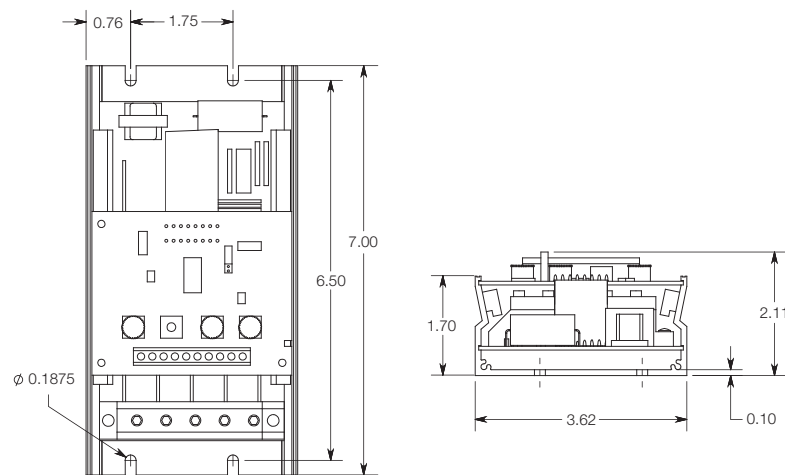

Enclosure type	Power				Speed Control			
	Supply Voltage (V)	Motor Voltage (V)	Current (A)		Closed loop	Speed pot.	DC signal	Digital control
			Cont.	Peak				
Chassis	12-48 VDC	12-48 VDC	20.0	40.0	x	x	0-6.25V	—

Units measured in inches.

Closed-loop speed control	Anodized chassis mount heatsink	Speed regulation: $\pm 1/2\%$ base speed
Quiet 15 kHz PWM switching	Internal supply for motor	Speed range: 60:1
MOSFET power devices	Hall-effect sensors	Length: 7.00 in.
5k Ω speed pot kit	Simple to operate	Width: 3.62 in.
Forward/reverse control	Low power inhibit circuit	Height: 2.11 in.

BRUSHLESS DC

750-30-0005

Model Number: DB1120D-4X

Brushless DC motor control technology is ideal if you're looking for quiet motor operation, long life expectancy for both drive and motor and high efficiency operation with low power loss. Its proven design is the first choice for tougher applications. This control provides variable speed operations for larger brushless DC motors and is compact and energy efficient. It is also able to produce speed commutation and control for motors with continuous ratings up to 1000 watts. This control is ideal when looking for high speed and quiet operation without the wear of brushes.

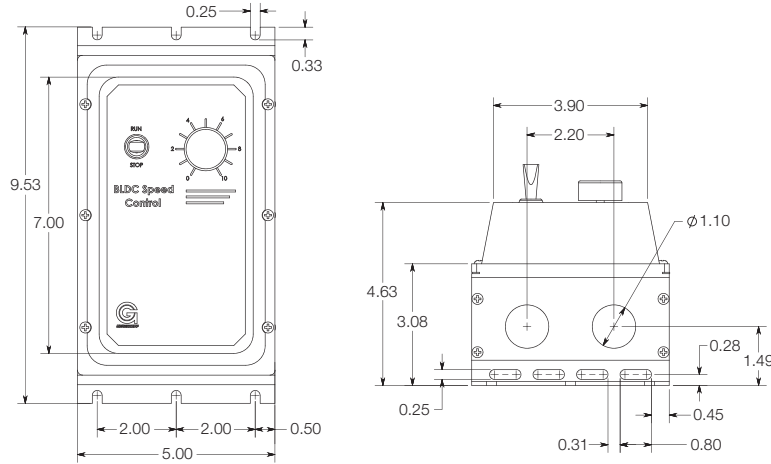

Enclosure type	Power				Speed Control			
	Supply Voltage (V)	Motor Voltage (V)	Current (A)		Closed loop	Speed pot.	DC signal	Digital control
			Cont.	Peak				
NEMA 4X	12-48 VDC	12-48 VDC	20.0	40.0	x	x	0-6.25V	—

Units measured in inches.

Closed-loop speed control

Quiet 15 kHz PWM switching

MOSFET power devices

5k Ω speed pot kit

Forward/reverse control

Anodized chassis mount heatsink

Internal supply for motor

Hall-effect sensors

Simple to operate

Low power inhibit circuit

Speed regulation: $\pm 1/2\%$ base speed

Speed range: 60:1

Length: 9.53 in.

Width: 5.00 in.

Height: 4.63 in.

Sold & Serviced By:

 **ELECTROMATE**

Toll Free Phone (877) SERV098

www.electromate.com

sales@electromate.com

750-30-0006

Model Number: DB2110D-2

Brushless DC motor control technology is ideal if you're looking for quiet motor operation, long life expectancy for both drive and motor, and high efficiency operation with low power loss. This proven design is the first choice for tougher applications. This control is compact and programmable, making it easy to operate. You can set your desired RPM rate by pressing the "up" and "down" buttons on the front panel. These settings will be exact, you can repeat them, and it will accurately control within 1/2 RPM of the desired speed. All wiring connects directly to a rugged screw type terminal strip through the rear panel. This DC brushless speed control has a digital closed loop and LED display for BLDC motors rated up to 400 watts.

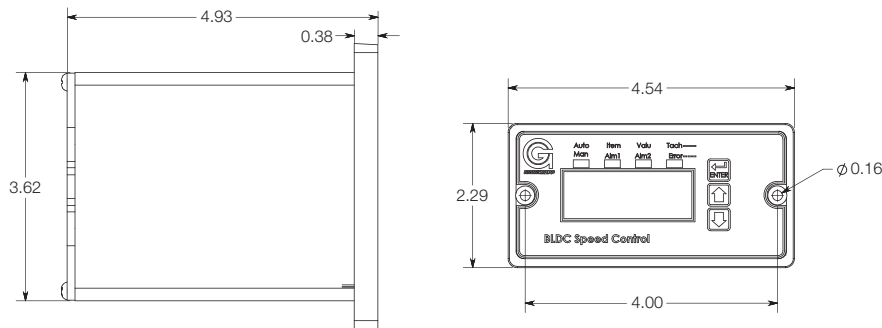

Enclosure type	Power				Speed Control			
	Supply Voltage (V)	Motor Voltage (V)	Current (A)		Closed loop	Speed pot.	DC signal	Digital control
			Cont.	Peak				
NEMA 4X	12-48 VDC	12-48 VDC	8.0	12.0	X	—	—	X

Units measured in inches.

Microprocessor-based design

Transient voltage protection

Configurable alarms/status and alarm indicators

Digital closed-loop accuracy to $\pm 1/2$ RPM

Jumper selection of drive output voltage

Program-enable jumper

Non-volatile memory stores

Self-contained power supply for motor halls

Length: 4.63 in.

Factory or field programmable via front panel

Large 4-digit 1/2" LED display

Width: 3.62 in.

Configure min/max speed

Forward/reverse control

Height: 1.66 in.

Features: acceleration, deceleration, brake, inhibit

Sold & Serviced By:



Toll Free Phone (877) SERV098

www.electromate.com

sales@electromate.com