

750-10-0000

Model Number: DA1225K-0

This control allows equipment to operate with Ground Fault Circuit Interruption circuit breakers or outlets. It saves time, is easy to install, and is simple to operate. It does not require programming and is able to be up and running in less than 10 minutes. This control provides overload protection, allowing motors to last longer by preventing motor burnout and eliminating nuisance tripping. It also saves energy as it only uses the power required for the application. Replacing constant speed with variable speed will significantly reduce energy costs as well.

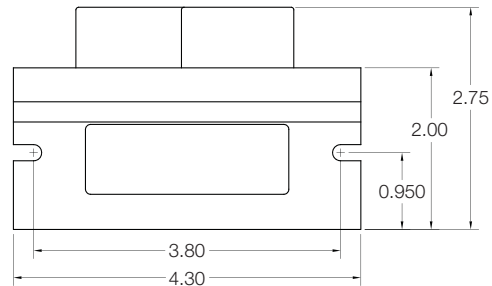
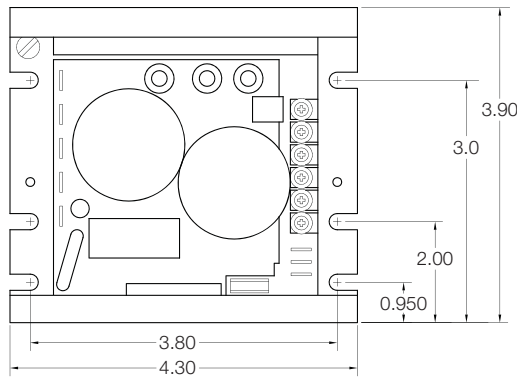

AC line input			Fuse or circuit breaker rating (A)	Drive output			Enclosure type
Voltage (V) 50/60 Hz	Phase (Ø)	Maximum Current (A)		Voltage range (V)	Max. cont. load current (RMS A/Ø)	Max. power HP KW	
115	1	9.6	15	0-230	2.4	1/2 0.37	Chassis
208/230		6.0	10				

Units measured in inches.

Diagnostic LEDs

Jumper selection of drive output frequency

Simple to operate

Slip compensation with static auto-tune and boost

Electric inrush current limit

Speed regulation: $\pm 2^{1/2}$ % base speed

Motor overload I²T with RMS current limit

Industry standard mounting

Speed range: 60:1

Undervoltage/overvoltage protection

Finger safe cover

Length: 3.90 in.

Microcontroller self monitoring and auto-reboot

MOV input transient suppression

Width: 4.30 in.

Features: acceleration, deceleration, brake, inhibit

Short circuit protection

Height: 2.75 in.

AC INDUCTION

750-10-0001

Model Number: DA1230K-0

This control allows equipment to operate with Ground Fault Circuit Interruption circuit breakers or outlets. It saves time, is easy to install, and is simple to operate. It does not require programming and is able to be up and running in less than 10 minutes. This control provides overload protection, allowing motors to last longer by preventing motor burnout and eliminating nuisance tripping. It also saves energy as it only uses the power required for the application. Replacing constant speed with variable speed will significantly reduce energy costs as well.

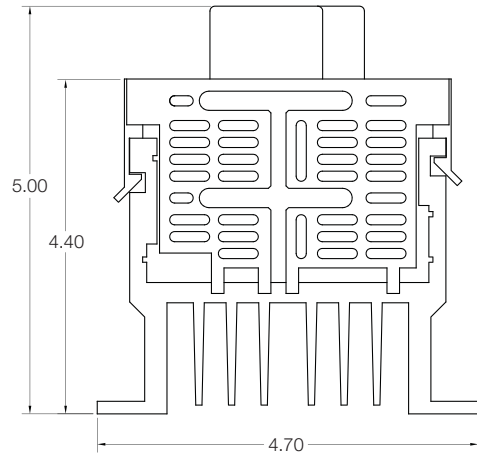
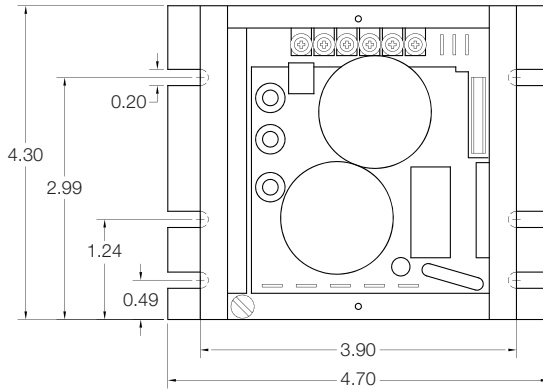

AC line input			Fuse or circuit breaker rating (A)	Drive output			Enclosure type
Voltage (V) 50/60 Hz	Phase (Ø)	Maximum Current (A)		Voltage range (V)	Max. cont. load current (RMS A/Ø)	Max. power HP KW	
115	1	14.0	20	0-230	4.0	1 0.75	Chassis
208/230		10.0	15				

Units measured in inches.

Diagnostic LEDs	Jumper selection of drive output frequency	Simple to operate
Slip compensation with static auto-tune and boost	Electric inrush current limit	Speed regulation: $\pm 2^{1/2}$ % base speed
Motor overload I ² T with RMS current limit	Industry standard mounting	Speed range: 60:1
Undervoltage/overvoltage protection	Finger safe cover	Length: 4.70 in.
Microcontroller self monitoring and auto-reboot	MOV input transient suppression	Width: 4.30 in.
Features: acceleration, deceleration, brake, inhibit	Short circuit protection	Height: 5.00 in.

Sold & Serviced By:



Toll Free Phone (877) SERV098
www.electromate.com
sales@electromate.com

750-10-0002

Model Number: DA1230K-4X

This control allows equipment to operate with Ground Fault Circuit Interruption circuit breakers or outlets. It saves time, is easy to install, and is simple to operate. It does not require programming and is able to be up and running in less than 10 minutes. This control provides overload protection, allowing motors to last longer by preventing motor burnout and eliminating nuisance tripping. It also saves energy as it only uses the power required for the application. Replacing constant speed with variable speed will significantly reduce energy costs as well.

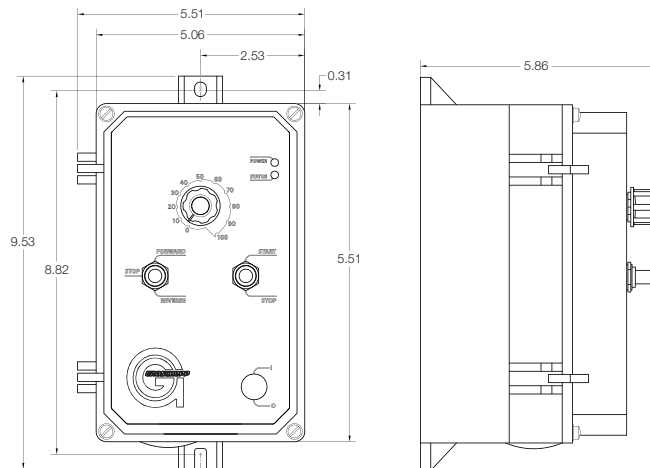

AC line input			Fuse or circuit breaker rating (A)	Drive output			Enclosure type
Voltage (V) 50/60 Hz	Phase (Ø)	Maximum Current (A)		Voltage range (V)	Max. cont. load current (RMS A/Ø)	Max. power HP KW	
115	1	14.4	20	0-208/230	3.6	1 0.75	NEMA 4X
208/230		8.1	15				

Units measured in inches.

Diagnostic LEDs	Motor HP selection jumper	Speed regulation: $\pm 2^{1/2}$ % base speed
Slip compensation	Inrush current limit	Speed range: 60:1
Motor overload I ² T	Holding torque at zero speed	Length: 9.53 in.
Short circuit protection	Industrial duty die-cast aluminum case with hinged cover	Width: 5.51 in.
Undervoltage/overvoltage protection	Features: acceleration, deceleration, brake, inhibit	Height: 5.86 in.

Sold & Serviced By:

 **ELECTROMATE**

Toll Free Phone (877) SERV098
www.electromate.com
sales@electromate.com

750-10-0003

Model Number: DA1215K-0

This control allows equipment to operate with Ground Fault Circuit Interruption circuit breakers or outlets. It saves time, is easy to install, and is simple to operate. It does not require programming and is able to be up and running in less than 10 minutes. This control provides overload protection, allowing motors to last longer by preventing motor burnout and eliminating nuisance tripping. It also saves energy as it only uses the power required for the application. Replacing constant speed with variable speed will significantly reduce energy costs as well.

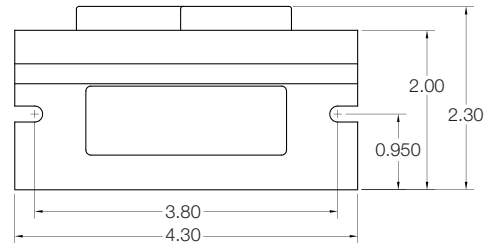
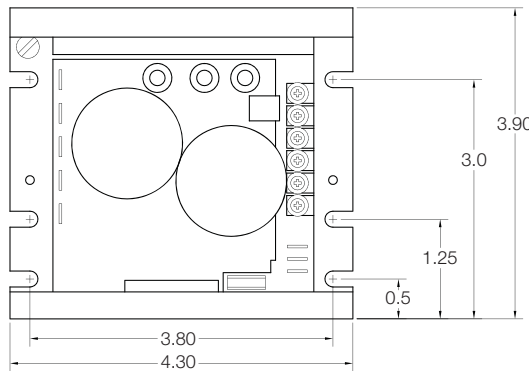

AC line input			Fuse or circuit breaker rating (A)	Drive output			Enclosure type
Voltage (V) 50/60 Hz	Phase (Ø)	Maximum Current (A)		Voltage range (V)	Max. cont. load current (RMS A/Ø)	Max. power HP KW	
115	1	4.0	5	0-230	1.0	1/10 0.07	Chassis
208/230		2.5	5				

Units measured in inches.

Diagnostic LEDs

Jumper selection of drive output frequency

Simple to operate

Slip compensation with static auto-tune and boost

Electric inrush current limit

Speed regulation: $\pm 2^{1/2}$ % base speed

Motor overload I²T with RMS current limit

Industry standard mounting

Speed range: 60:1

Undervoltage/overvoltage protection

Finger safe cover

Length: 3.90 in.

Microcontroller self monitoring and auto-reboot

MOV input transient suppression

Width: 4.30 in.

Features: acceleration, deceleration, brake, inhibit

Short circuit protection

Height: 2.30 in.

AC INDUCTION

750-10-0004

Model Number: DA1215K-1

This control allows equipment to operate with Ground Fault Circuit Interruption circuit breakers or outlets. It saves time, is easy to install, and is simple to operate. It does not require programming and is able to be up and running in less than 10 minutes. This control provides overload protection, allowing motors to last longer by preventing motor burnout and eliminating nuisance tripping. It also saves energy as it only uses the power required for the application. Replacing constant speed with variable speed will significantly reduce energy costs as well.

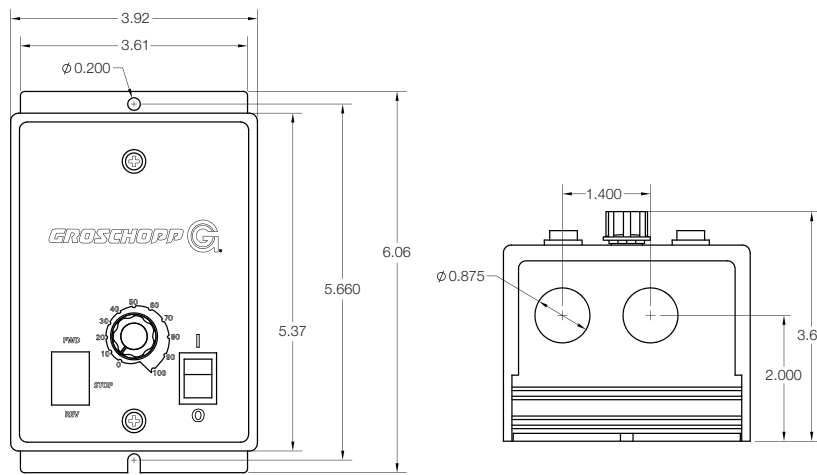

AC line input			Fuse or circuit breaker rating (A)	Drive output			Enclosure type	
Voltage (V) 50/60 Hz	Phase (ϕ)	Maximum Current (A)		Voltage range (V)	Max. cont. load current (RMS A/ ϕ)	Max. power		
						HP	KW	
115	1	4.0	5	0-230	1.0	1/10	0.07	IP50
208/230		2.5						

Units measured in inches.

Diagnostic LEDs

Dual voltage AC line input

Motor overload I²T with RMS current limit

Undervoltage/overvoltage protection

Factory installed ON/OFF AC line switch and main speed potentiometer

Forward-stop-reverse switch

Short circuit protection

Jumper selection from drive output frequency (J1 and J2)

Automatic and manual start (CON1), and motor direction (CON2)

Electronic inrush current limit

Flux vector control with static auto-tune

Regeneration protection

Simple to operate

Features: acceleration, deceleration, brake, inhibit

Speed regulation: $\pm 2^{1/2}$ % base speed

Speed range: 60:1

Length: 6.06 in.

Width: 3.92 in.

Height: 3.65 in.

AC INDUCTION

750-10-0005

Model Number: DA1225K-1

This control allows equipment to operate with Ground Fault Circuit Interruption circuit breakers or outlets. It saves time, is easy to install, and is simple to operate. It does not require programming and is able to be up and running in less than 10 minutes. This control provides overload protection, allowing motors to last longer by preventing motor burnout and eliminating nuisance tripping. It also saves energy as it only uses the power required for the application. Replacing constant speed with variable speed will significantly reduce energy costs as well.

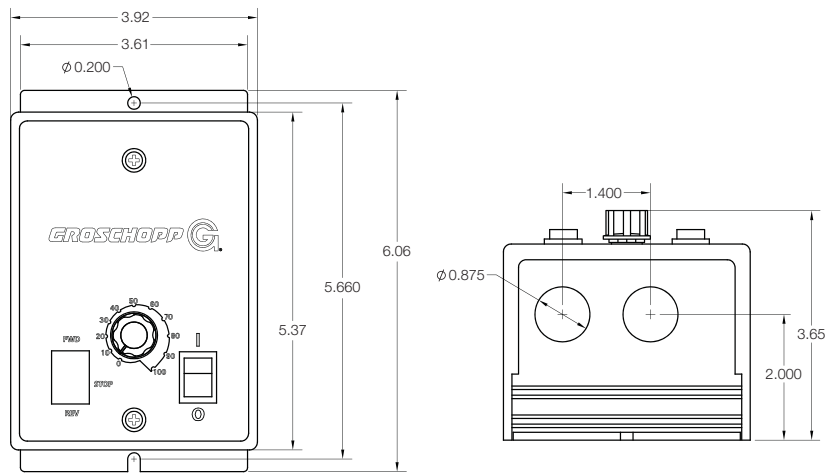

AC line input			Fuse or circuit breaker rating (A)	Drive output			Enclosure type
Voltage (V) 50/60 Hz	Phase (Ø)	Maximum Current (A)		Voltage range (V)	Max. cont. load current (RMS A/Ø)	Max. power HP KW	
115	1	4.0	15	0-230	2.2	1/2 0.37	IP20
208/230		6.0			2.4		

Units measured in inches.

Diagnostic LEDs

Dual voltage AC line input

Motor overload I²T with RMS current limit

Undervoltage/overvoltage protection

Factory installed ON/OFF AC line switch and main speed potentiometer

Forward-stop-reverse switch

Short circuit protection

Jumper selection from drive output frequency (J1 and J2)

Automatic and manual start (CON1), and motor direction (CON2)

Electronic inrush current limit

Flux vector control with static auto-tune

Regeneration protection

Simple to operate

Features: acceleration, deceleration, brake, inhibit

Speed regulation: $\pm 2^{1/2}$ % base speed

Speed range: 60:1

Length: 6.06 in.

Width: 3.92 in.

Height: 3.65 in.

Sold & Serviced By:

ELECTROMATE

Toll Free Phone (877) SERV098

www.electromate.com

sales@electromate.com